



Biodiversity Net Gain case study
Michael Syddall Church Of England
Primary School, Catterick Village,
North Yorkshire

Introduction

The following case study is one in a series showcasing practical examples of how Biodiversity Net Gain (BNG) has been successfully delivered in real-world planning applications.

This example illustrates the creative and effective integration of BNG principles, aligning with the objectives outlined in Chapter 3: Practical Implementation of BNG on Site from the Sport England Biodiversity Net Gain Guidance. The project demonstrates how thoughtful design can maximise ecological and educational benefit. The Michael Syddall Church of England Primary School highlights an innovative solution that balances biodiversity enhancements with site functionality, achieving measurable net gains. This case study serves as inspiration and guidance for integrating BNG into diverse site contexts.



Michael Syddall Church Of England Primary School, Catterick Village, North Yorkshire

Introduction

The proposed development at Michael Syddall Church of England Primary School involves the demolition of the existing school building and the construction of a new single-storey school building. The project includes associated access, car and cycle parking, the creation of a replacement playing field, and landscape enhancements to improve the overall site and its functionality including social areas. The proposal is illustrated on the image on page 4.

BNG baseline

The main school building on the site is set to be demolished as part of the proposed works. The baseline biodiversity of the site consists mainly of modified grassland, a large playing field to the south that is regularly mown. The species richness is low. Additionally, there are ground-level planters, a native hedgerow in poor condition, and scattered trees in moderate condition across the site.



Baseline habitat plan









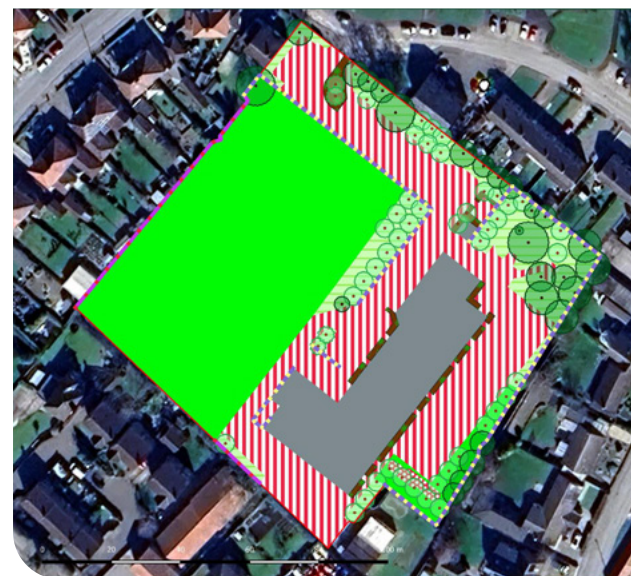



-  Site boundary
-  Trees
-  Native hedgerow
-  Ground level planters
-  Developed land, sealed surface
-  Buildings
-  Modified grassland



Post development habitat plan



-  Site Boundary
-  u1b5 - Buildings
-  u1b6 - Developed land, sealed surface
-  U1c - Created unsealed surface
-  g4 - Modified grassland
-  g3c - Other neutral grassland
-  u1 845 - Ground level planters
-  h2a - Retained native hedgerow
-  h2a - Created native hedgerow
-  g 32 - Retained Trees
-  g 32 - Created Trees

BNG Delivery Strategy

The proposals for biodiversity delivery at Michael Syddall Church Of England Primary School include:

- Creation of neutral grassland habitat.
- Native Hedgerows: partially retained and partially created along the parameter of the playing fields and the site itself.
- Retention of existing trees and planting new trees throughout the site.

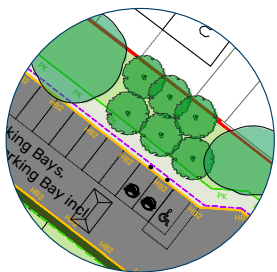
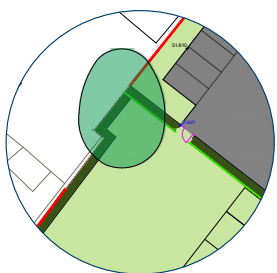
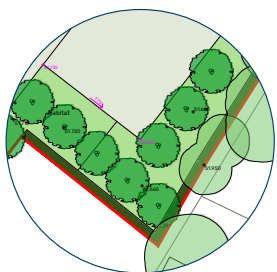

01 Utilisation of Fringe Spaces

The landscape proposals ensure effective use of fringe spaces unsuitable for playing pitches, utilising them for Biodiversity Net Gain delivery through features such as tree planting and plant mixes to support BNG.

02 Site Boundaries

The site boundaries will be enhanced with new hedgerows and additional planting to improve biodiversity and ecological connectivity.

03 Use of Non-Recreational Site Areas

The entrance area contributes to Biodiversity Net Gain through tree planting around the car parking areas. This scheme also has tree planting within social spaces. These measures enhance both biodiversity and the site's functionality.



User guide

This guidance is provided for general information only Sport England is not your adviser and any reliance you may place on this guidance is at your own risk. Sport England, nor any contributor to the content of this guidance shall be responsible for any loss or damage of any kind, which may arise from your use of or reliance on this guidance. Care has been taken over the accuracy of the content of this guidance but Sport England cannot guarantee that the information is up to date or reflects all relevant legal requirements.

As with all guidance, you should always appoint an appropriate professional team with relevant expertise to take your project forwards.

Document accessibility

This document has been designed for comfortable reading at A4 and on a laptop screen but can also be printed at A3 for large print versions. The pdf is accessible and has been tested to work with text readers.

Acknowledgements

Sport England wishes to thank LUC for contributing to this document and those involved with the project that gave us permission to use this as a case study.

Image credits

- (1) Sport England
- (2) Map data ©2026 Google
- (3) KPS Limited / Arbtech / One Environments
- (4) KPS Limited / Arbtech / One Environments





Sport England
SportPark
3 Oakwood Drive
Loughborough
Leicestershire
LE11 3QF

[sportengland.org](https://www.sportengland.org)

March 2026