

# KEY

- ① Profiled steel insulated composite cladding on sheeting rails.
- ② Automatic sliding doors to BS 7036 1500mm wide, c/w escape break out side glazing and pocket screens.
- ③ Powder coated aluminium double glazed windows / curtain walling.
- ④ Glazed canopy over entrance.
- ⑤ Metal escape doors, faced flush with rebound boards.
- ⑥ Up-and-over equipment store door 2.4 x 2.4m with flush rebound face to match wall.
- ⑦ Perimeter wall FR grade laminate faced FR water/boil proof ply rebound board wall to perimeter of sports hall up to 2.55m high, coloured fine acoustic mesh infill netting hung full height above.
- ⑧ Severe duty drywall partitions/lining c/w plywood sheathing, high impact wall board and acoustic quilt.
- ⑨ Internal glazed screen and door into sports hall - flush faced and impact resistant.
- ⑩ Protection rails to doors.
- ⑪ Lockers - third height + full height for disabled use.
- ⑫ Meter/plant room.
- ⑬ Cleaner's Store c/w sink.
- ⑭ Vending machine space.
- ⑮ Wheelchair / secure buggy storage.
- ⑯ Accessible WC (ASF Fig 24).
- ⑰ Notice board/hall of fame gallery.
- ⑱ Draft lobby c/w barrier matting.
- ⑲ Sports hall flooring to BSEN 14904 A3 Area Elastic c/w court lines.
- ⑳ Powerfloated concrete slab with epoxy floor paint.
- ㉑ Slip resistant vinyl sheet flooring.
- ㉒ Magnetic whiteboard.
- ㉔ Ambulant WC (ASF Fig 27).
- ㉕ Accessible Shower (ASF Fig 23).
- ㉖ Accessible CH/WC (ASF Fig 18).
- ㉗ Shower cubicle.
- ㉘ Mezzanine plant room above shown dotted.
- ㉙ Slip-resistant ceramic tiling.
- ㉚ Changing bench seating inc accessible bench section.
- ㉛ Metal escape doors.
- ㉜ Sports Hall informal viewing area.
- ㉝ Public telephone.
- ㉞ Reception desk.
- ㉟ Showers with accessible shower seat (ASF Fig 14).
- ㊱ Store.
- ㊲ Sports Hall informal viewing area.
- ㊳ Accessible CH/WC (ASF Fig 16).
- ㊴ Area elastic structured timber sprung floor to BSEN 14904.
- ㊵ Commercial carpet tiles plus high density mats to free weights area.
- ㊶ Commercial carpet tiles.

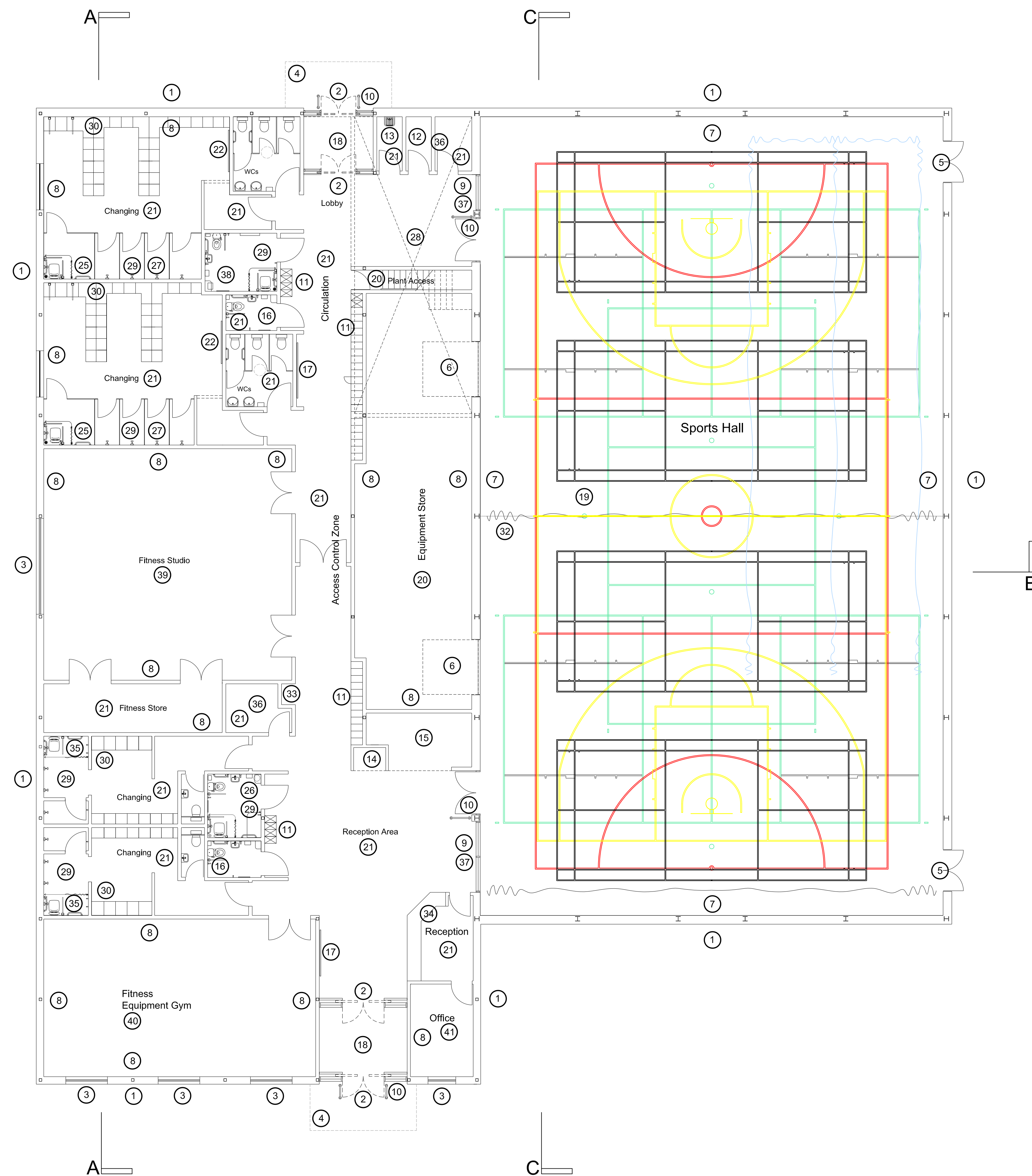

*Affordable Sports Halls*

## Option 1c Floor Plan

**Sports Hall +CH / HF**

Scale: 0 5000 mm

Date: July 2015

**Notes:**  
 This drawing is an extract from Sport England's publication *'Affordable Sports Halls'* and must be read in conjunction with the respective section of the guidance  
 DO NOT SCALE FROM THIS DRAWING  
 (approx 1:200 @ A3; approx 1:100 @ A1)  
 ALL DIMENSIONS ARE IN MILLIMETRES

[Click here for 'Design and Cost Guidance'](#)

[Click here for 'User Guide'](#)