

### Introduction

The following sports data sheets are for use in conjunction with Sport England's 'Developing the Right Sports Hall' (DRSH) main document. They relate to Step 5 'Establishing the Project Brief' and identify the needs of the priority sport and the key secondary sports.

These sheets show the requirements for volleyball as the 'Priority Sport' at various levels of play and other 'Secondary Sports' that can fit into the same overall space.

	Level of Play			
New Level of Play Category <sup>1</sup>	International	Premier	Club	Community
	This category relates to the lowest level of International play <sup>2</sup>	This category relates a Premier / National League Club competing in regional or Inter county competitions	This category relates to a local club competing in District and County League competitions	This category relates to school and community use where there is no formal competitive structure / no specific need for space for officials or spectator accommodation
Volleyball equivalent <sup>3</sup>	International	National League Club	Club	Practice and school sport

### Commentary

The sports data sheets use the NGB's requirements for the field of play. The additional space requirements for officials are indicated separately as 'optional'. Spectators zones for match play are not included and are assumed to be a site specific requirement. For further details of the requirements for volleyball, see the Volleyball England (VE) website: <http://www.volleyballengland.org>. For further details of the requirements for 'secondary sports', see Appendix 8 of the main DRSH document for links to other NGB's websites.

<sup>1</sup> New level of play categories for each sport as agreed by the NGBs and Sport England and applicable throughout this document.

<sup>2</sup> For higher levels of international competition, such as major championships, the relevant NGB should be consulted at a very early stage as the requirements vary considerably.

<sup>3</sup> For other sports, see Appendix 4 'Level of play categories for each sport' within main document.



### Key Issues

- **Court markings:** Lines must be of a light colour which is different from the colour of the floor and from any other lines. (The standard colour for volleyball is green). Where volleyball usage is likely to be high there is a preference to lay down markings over others so that lines are continuous and uninterrupted.
- **Hall heights:** All dimensions indicated are clear unobstructed heights i.e. any beams / lights / services must be above the clear height requirements.
- **Flooring:** Ground sockets for drop in posts are required for new build halls. Floor anchor fixings are only recommended by VE for retro fit projects. For International events, ground sockets must conform to FIVB requirements. Flooring to be area elastic category.
- **Lighting:** Volleyball is particularly sensitive to direct overhead lighting, especially over the net area. Players need to look up to watch the descent of the ball and lighting in the net area can be blinding if badly placed or inappropriate light sources are used. Technical guidance notes produced by Sport England recommend that the levels for multi-purpose halls should also be increased to 500 lux, and the fittings switched to provide for 2 or 3 lower levels of illumination. All lighting must be protected against ball impact. Uniformity ratio = Emin / eav.

**Note:** For further details see Volleyball England's website and Sport England's design guidance notes 'Sports Halls Design and Layouts', 'Floors for Indoor Sports' and 'Artificial Sports Lighting'.

### Primary Sport

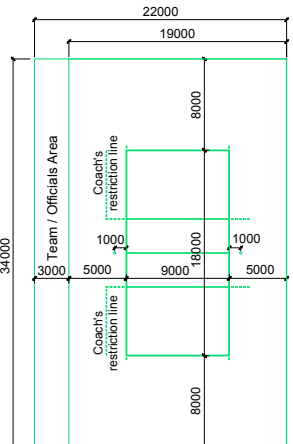
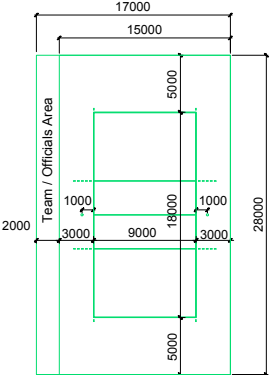
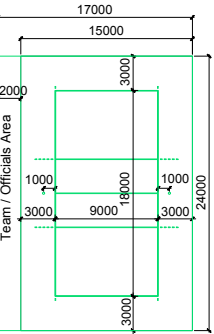
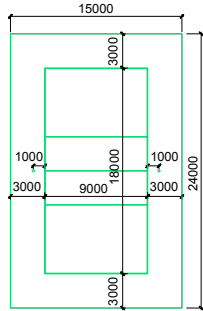
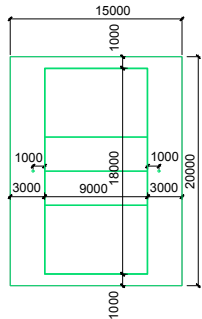
<b>Volleyball - Overview</b>			Source of information: <a href="http://www.volleyballengland.org">http://www.volleyballengland.org</a> Facilities Strategy Technical Guidelines 'download4890'														
<b>International</b>		<b>Premier</b>		<b>Overall space (m) incl. R/O + T/O</b>													
				<b>Principal playing area (m)</b>			<b>Run offs (m) R/O</b>		<b>Additional areas (m) T/O SS</b>		<b>Specification</b>						
				<b>L x W x H</b>	Length	Width	Height	Ends	Sides	Between courts / Between courts with a dividing net	Space for teams (T) and match officials (O)	Spectator seating	Flooring	Lighting			
				<b>International</b>	<b>34.00</b> <b>22.00</b> <b>12.50</b>	18.00	9.00	12.50	8.00	5.00	10.00 or 13.00 / 10.00 or 13.00	3.00	-	Area elastic	1000 - 1500 lux 0.7 Emin / eav		
				<b>Premier</b>	<b>28.00</b> <b>17.00</b> <b>7.50</b>	18.00	9.00	7.50	5.00	3.00	6.00 or 8.00 / 6.00 or 8.00	2.00	-	Area elastic	500 lux 0.7 Emin / eav		
<b>Club</b>		<b>Community</b>		<b>Training</b>													
						<b>Club</b>	<b>24.00</b> <b>17.00</b> <b>7.50</b>	18.00	9.00	7.50	3.00	3.00	6.00 or 8.00 / 6.00 or 8.00	2.00	-	Area elastic	500 lux 0.7 Emin / eav
				<b>Community</b>	<b>24.00</b> <b>15.00</b> <b>7.50</b>	18.00	9.00	7.50	3.00	3.00	6.00 / 6.00	N/A	N/A	Area elastic	500 lux 0.7 Emin / eav		
				<b>Training</b>	<b>20.00</b> <b>15.00</b> <b>7.50</b>	18.00	9.00	7.50	1.00	3.00	6.00 / 6.00	N/A	N/A	Area elastic	500 lux 0.7 Emin / eav		

### Primary Sport

Volleyball				Source of information:		<a href="http://www.volleyballengland.org">http://www.volleyballengland.org</a> Facilities Strategy Technical Guidelines 'download4890'											
International				Overall space (m) incl. R/O + T/O <b>34.00 x 22.00 x 12.50</b>													
				Principal playing area (m)			Run offs (m)			Additional areas (m)		Specification					
				L x W x H	Length	Width	Height	Ends	Sides	Between courts / Between courts with a dividing net	T/O	SS	Flooring	Lighting			
				<b>34.00</b>	18.00	9.00	12.50	8.00	5.00	10.00 or 13.00 / 10.00 or 13.00	3.00	-	Area elastic	1000 - 1500 lux 0.7 Emin/eav			
Secondary Sports																	
Sport	Number	Compliance	Level														
Badminton	4 court format (including 1 dividing net)	✓	Premier	<b>33.00</b> 17.40 9.00	13.40	6.10	9.00	2.00	1.50	1.50 / 2.60	-	-	Combined, area or mixed elastics	Lower (500 lux)			
Basketball	1 court format	✓	Club	<b>32.10</b> 20.10 7.00	28.00	15.00	7.00	2.05	2.05	4.10 / 4.10	1.00	-	Semi-sprung wooden or synthetic	Lower (500 lux)			
Netball	0 court format	✗	-	<b>34.50</b> 18.25 7.50	30.50	15.25	7.50	2.00	1.50	3.00 / 3.00	-	-	Any meeting AENA standards	Lower (750 lux)			
Indoor Cricket	4 lanes	✓	Community / Club	<b>33.62</b> 20.04 7.70	31.62	3.66	7.70	1.00	1.00	3.40 for basket - ball goal	-	-	Mats req/d (to ECB standards)	Lower (750 lux)			
Volleyball Training	2 court format (transverse)	✓	Training	<b>30.00</b> 20.00 7.50	18.00	9.00	7.50	1.00	3.00	6.00 / 6.00	-	-	Area elastic	Lower (500 lux)			
Basketball Training	Rings on side walls	✓	Training	-													

### Primary Sport / Secondary Sport Issues

## Volleyball - International (cont/d)

#### Notes of key issues for international volleyball

- See 'Key Issues' on page 1 cover sheet.
- Hatched areas indicate space which is excess to secondary sport minimum requirements. In some cases, this can provide improved circulation and space for spectators and wheelchair users.
- Ground sockets are required to conform to FIVB requirements for International events.
- For International level courts, netball training run offs require consideration if incorporated.
- The safety margins indicated between the cricket practice nets and walls have been increased to allow basketball training goals fitted to the side walls - see the ECB TS3 document for further advice.
- Basketball practice rings can be related to the volleyball training court (see diagram below for volleyball / basketball training) or placed independently without any specific court markings.

### Secondary Sports

Layouts for other sports within an international volleyball space of 34.00 x 22.00 x 12.50 m

#### Badminton

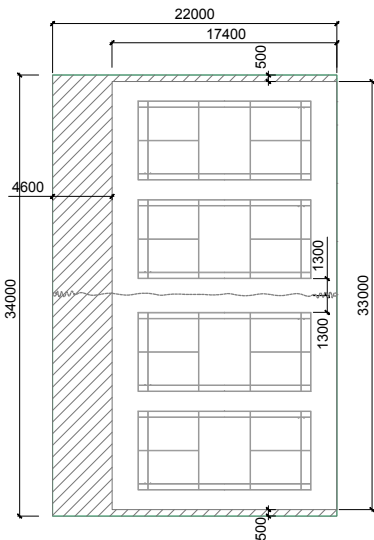

#### Basketball

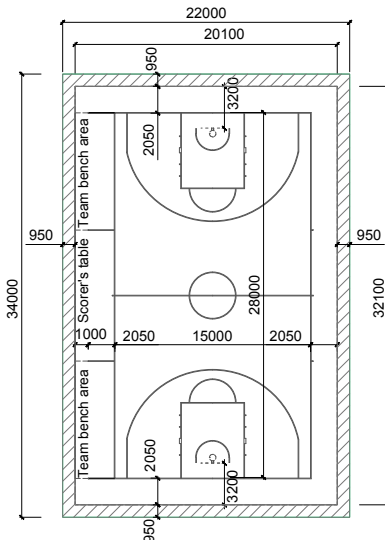

#### Netball (Community)

- cannot be accommodated in a single international volleyball space, unless it is made longer

#### Indoor Cricket

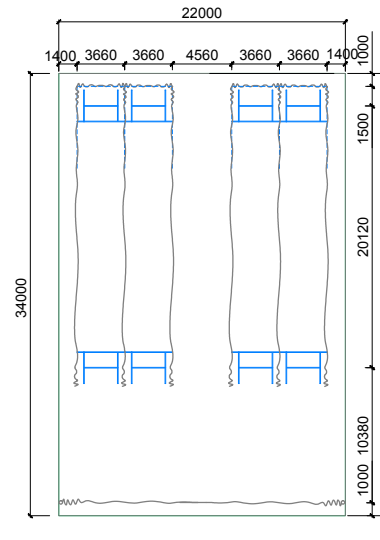

#### Volleyball/Basketball Training

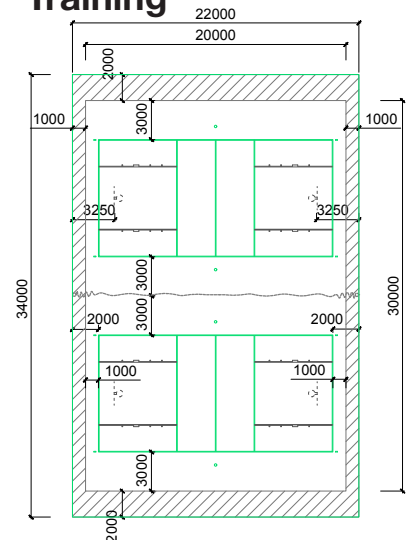

### Primary Sport

<b>Volleyball</b>				Source of information:		<a href="http://www.volleyballengland.org">http://www.volleyballengland.org</a> Facilities Strategy Technical Guidelines 'download4890'											
<b>Premier</b>				<b>Overall space (m) incl. R/O + T/O</b> <b>28.00 x 17.00 x 7.50</b>													
<p>The diagram shows a rectangular hall with an overall width of 17,000m and an overall length of 28,000m. A central 'Team / Officials Area' is 18,000m long and 9,000m wide. This area is flanked by 5,000m wide run-off zones. The principal playing area is 18,000m long, 9,000m wide, and 7,500m high. Run-off zones are 5,000m at the ends and 3,000m on the sides. Additional areas include 2,000m for teams and match officials, and 1,000m for spectator seating.</p>				<b>Principal playing area (m)</b>			<b>Run offs (m)</b>			<b>Additional areas (m)</b>		<b>Specification</b>					
							<b>R/O</b>			<b>T/O</b>	<b>SS</b>						
				<b>L x W x H</b>	Length	Width	Height	Ends	Sides	Between courts / Between courts with a dividing net	Space for teams (T) and match officials (O)	Spectator seating	Flooring	Lighting			
	<b>28.00</b>	<b>17.00</b>	<b>7.50</b>	18.00	9.00	7.50	5.00	3.00	6.00 or 8.00 / 6.00 or 8.00	2.00	-	Area elastic	500 lux 0.7 Emin / eav				
<b>Secondary Sports</b>																	
Sport	Number	Compliance	Level														
Badminton	2 court format	✓	Club	17.40 16.70 7.50	13.40	6.10	7.50	2.00	1.50	1.50 / 2.60	-	-	Combined, area or mixed elastics	Same (500 lux)			
Basketball	0 court format	✗	-	32.10 19.10 7.00	28.00	15.00	7.00	2.05	2.05	-	-	-	Semi-sprung wooden or synthetic	Same (500 lux)			
Netball	0 court format	✗	-	34.50 18.25 7.50	30.50	15.25	7.50	2.00	1.50	-	-	-	Any meeting AENA standards	Higher (750 lux)			
Indoor Cricket	0 lanes	✗	-	33.62 12.72 7.70	31.62	3.66	7.70	1.00	1.00	3.40 for basket - ball goal	-	-	Mats req/d (to ECB standards)	Higher (750 lux)			
Volleyball Training	0 court format (transverse)	✗	-	20.00 15.00 7.50	18.00	9.00	7.50	1.00	3.00	6.00 / 6.00	N/A	N/A	Area elastic	Same (500 lux)			
Basketball Training	Rings on side walls	✓	Training	-													

### Primary Sport / Secondary Sport Issues

## Volleyball - Premier (cont/d)

#### Notes of key issues for premier volleyball

- See 'Key Issues' on page 1 cover sheet.
- Hatched areas indicate space which is excess to secondary sport requirements. In some cases, this can provide improved circulation and space for spectators and wheelchair users.

### Secondary Sports

Layouts for other sports within a premier volleyball space of 28.00 x 17.00 x 7.50 m

#### Badminton

#### Netball

#### Basketball

#### Cricket

#### Volleyball Training (transverse)

#### Basketball Training

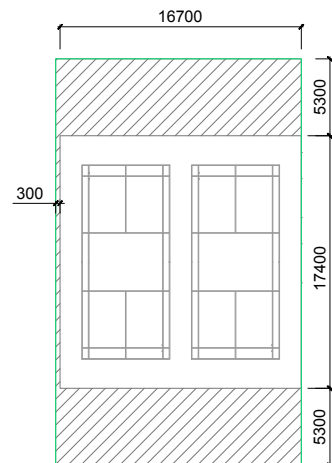

- cannot be accommodated in a single premier volleyball space

- can be accommodated in a single premier volleyball space  
- number and location to project specific requirements

### Primary Sport

Volleyball				Source of information:		<a href="http://www.volleyballengland.org">http://www.volleyballengland.org</a> Facilities Strategy Technical Guidelines 'download4890'									
Club				Overall space (m) incl. R/O + T/O <b>24.00 x 17.00 x 7.50</b>											
				Principal playing area (m)			Run offs (m)			Additional areas (m)		Specification			
				L x W x H	Length	Width	Height	Ends	Sides	Between courts / Between courts with a dividing net	T/O Space for teams (T) and match officials (O)	SS Spectator seating	Flooring	Lighting	
				24.00 17.00 7.50	18.00	9.00	7.50	3.00	3.00	6.00 or 8.00 / 6.00 or 8.00	2.00	-	Area elastic	500 lux 0.7 Emin / eav	
Secondary Sports															
Sport	Number	Compliance	Level	L x W x H	Length	Width	Height	Ends	Sides	Between courts / Between courts with a dividing net	T/O Space for teams (T) and match officials (O)	SS Spectator seating	Flooring	Lighting	
Badminton	2 court format	✓	Club	17.40 16.70 7.50	13.40	6.10	7.50	2.00	1.50	1.50 / 2.60	-	-	Combined, area or mixed elastics	Same (500 lux)	
Basketball	0 court format	✗	-	32.10 19.10 7.00	28.00	15.00	7.00	2.05	2.05	-	-	-	Semi- sprung wooden or synthetic	Same (500 lux)	
Netball	0 court format	✗	-	34.50 18.25 7.50	30.50	15.25	7.50	2.00	1.50	-	-	-	Any meeting AENA standards	Higher (750 lux)	
Indoor Cricket	0 lanes	✗	-	33.62 12.72 7.70	31.62	3.66	7.70	1.00	1.00	3.40 for basket - ball goal	-	-	Mats req/d (to ECB standards)	Higher (750 lux)	
Volleyball Training	0 court format (transverse)	✗	-	20.00 15.00 7.50	18.00	9.00	7.50	1.00	3.00	6.00 / 6.00	N/A	N/A	Area elastic	Same (500 lux)	
Basketball Training	Rings on side walls	✓	Training	-											

### Primary Sport / Secondary Sport Issues

## Volleyball - Club (cont/d)

#### Notes of key issues for club volleyball

- See 'Key Issues' on page 1 cover sheet.
- Hatched areas indicate space which is excess to secondary sport requirements. In some cases, this can provide improved circulation and space for spectators and wheelchair users.

### Secondary Sports

Layouts for other sports within a club volleyball space of 24.00 x 17.00 x 7.50 m

**Badminton**

**Netball**

**Basketball**

**Cricket**

**Volleyball Training  
(transverse)**

**Basketball  
Training**

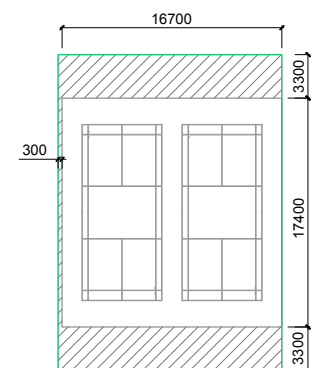

- cannot be accommodated in a single club volleyball space

- can be accommodated in a single club volleyball space

- number and location to project specific requirements



### Primary Sport

<b>Volleyball</b>				Source of information:		<a href="http://www.volleyballengland.org">http://www.volleyballengland.org</a> Facilities Strategy Technical Guidelines 'download4890'									
<b>Community</b>				<b>Overall space (m) incl. R/O + T/O</b> <b>24.00 x 15.00 x 7.50</b>											
				<b>Principal playing area (m)</b>			<b>Run offs (m)</b>			<b>Additional areas (m)</b>		<b>Specification</b>			
							<b>R/O</b>			<b>T/O SS</b>					
				<b>L x W x H</b>	Length	Width	Height	Ends	Sides	Between courts / Between courts with a dividing net	Space for teams (T) and match officials (O)	Spectator seating	Flooring	Lighting	
				<b>24.00</b>	18.00	9.00	7.50	3.00	3.00	6.00 / 6.00	N/A	N/A	Area elastic	500 lux 0.7 Emin / eav	
<b>Secondary Sports</b>															
Sport	Number	Compliance	Level												
Badminton	1 court format	✓	Community	17.40 9.10 6.70	13.40	6.10	6.70	2.00	1.50	1.50 / 2.40	-	-	Combined, area or mixed elastics	Same (500 lux)	
Basketball	0 court format	✗	-	32.10 19.10 7.00	28.00	15.00	7.00	2.05	2.05	-	-	-	Semi-sprung wooden or synthetic	Same (500 lux)	
Netball	0 court format	✗	-	34.50 18.25 7.50	30.50	15.25	7.50	2.00	1.50	-	-	-	Any meeting AENA standards	Higher (750 lux)	
Indoor Cricket	0 lanes	✗	-	33.62 12.72 7.70	31.62	3.66	7.70	1.00	1.00	3.40 for basket - ball goal	-	-	Mats req/d (to ECB standards)	Higher (750 lux)	
Volleyball Training	0 court format (transverse)	✗	-	20.00 15.00 7.50	18.00	9.00	7.50	1.00	3.00	6.00 / 6.00	N/A	N/A	Area elastic	Same (500 lux)	
Basketball Training	Rings on side walls	✓	Training	-											

### Primary Sport / Secondary Sport Issues

## Volleyball - Community (cont/d)

#### Notes of key issues for community volleyball

- See 'Key Issues' on page 1 cover sheet.
- Hatched areas indicate space which is excess to secondary sport requirements. In some cases, this can provide improved circulation and space for spectators and wheelchair users.
- Removable wall mountings at each end of the hall to support a continuous net along the centre of the hall and coinciding with the net lines of badminton courts (and volleyball training courts) for teaching, small sided games and sitting volleyball.

### Secondary Sports

Layouts for other sports within a community volleyball space of 24.00 x 15.00 x 7.50 m

#### Badminton

#### Netball

#### Basketball

#### Cricket

#### Volleyball Training (transverse)

#### Basketball Training

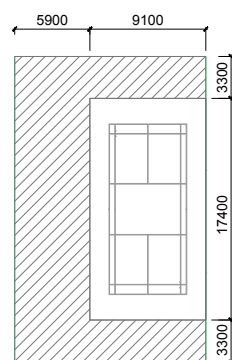

- cannot be accommodated in a single community volleyball space

- can be accommodated in a single community volleyball space  
- number and location to project specific requirements

### Primary Sport

<b>Volleyball</b>				Source of information:		<a href="http://www.volleyballengland.org">http://www.volleyballengland.org</a> Facilities Strategy Technical Guidelines 'download4890'									
<b>Training</b>				<b>Overall space (m) incl. R/O + T/O</b> <b>20.00 x 15.00 x 7.50</b>											
				<b>Principal playing area (m)</b>			<b>Run offs (m)</b>			<b>Additional areas (m)</b>		<b>Specification</b>			
				<b>L x W x H</b>	<b>Length</b>	<b>Width</b>	<b>Height</b>	<b>Ends</b>	<b>Sides</b>	<b>Between courts / Between courts with a dividing net</b>	<b>T/O</b>	<b>SS</b>	<b>Flooring</b>	<b>Lighting</b>	
				<b>20.00 15.00 7.50</b>	18.00	9.00	7.50	1.00	3.00	6.00 / 6.00	N/A	N/A	Area elastic	500 lux 0.7 Emin / eav	
<b>Secondary Sports</b>															
Sport	Number	Compliance	Level												
Badminton	1 court format	✓	Community	17.40 9.10 7.50	13.40	6.10	6.70	2.00	1.50	1.50 / 2.40	-	-	Area or combined elastics	Same (500 lux)	
Basketball	0 court format	✗	-	32.10 19.10 7.00	28.00	15.00	7.00	2.05	2.05	-	-	-	Semi-sprung wooden or synthetic	Same (500 lux)	
Netball	0 court format	✗	-	34.50 18.25 7.50	30.50	15.25	7.50	2.00	1.50	-	-	-	Any meeting AENA standards	Higher (750 lux)	
Indoor Cricket	0 lanes	✗	-	33.62 12.72 7.70	31.62	3.66	7.70	1.00	1.00	3.40 for basket - ball goal	-	-	Mats req/d (to ECB standards)	Higher (750 lux)	
Volleyball Training	1 court format (transverse)	✓	Training	20.00 15.00 7.50	18.00	9.00	7.50	1.00	3.00	6.00 / 6.00	N/A	N/A	Area elastic	Same (500 lux)	
Basketball Training	Rings on side walls	✓	Training												

### Primary Sport / Secondary Sport Issues

## Volleyball - Training (cont/d)

#### Notes of key issues for volleyball training

- See 'Key Issues' on page 1 cover sheet.
- Hatched areas indicate space which is excess to secondary sport requirements. In some cases, this can provide improved circulation and space for spectators and wheelchair users.
- The principles of this Volleyball training court have been proposed by Volleyball England and incorporates reduced end run off margins, subject to risk assessment on a site-by-site basis.
- Removable wall mountings at each end of the hall to support a continuous net along the centre of the hall and coinciding with the net lines of badminton courts (and volleyball training courts) for teaching, small sided games and sitting volleyball.

### Secondary Sports

Layouts for other sports within a volleyball training space of 20.00 x 15.00 x 7.50 m

#### Badminton

#### Netball

#### Basketball

#### Cricket

#### Basketball Training

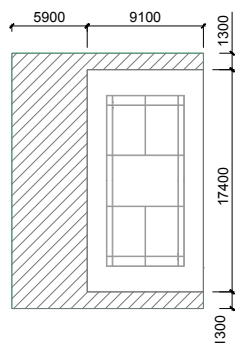

- cannot be accommodated in a single volleyball training space

- can be accommodated in a single volleyball training space
- number and location to project specific requirements